

MODEL GC

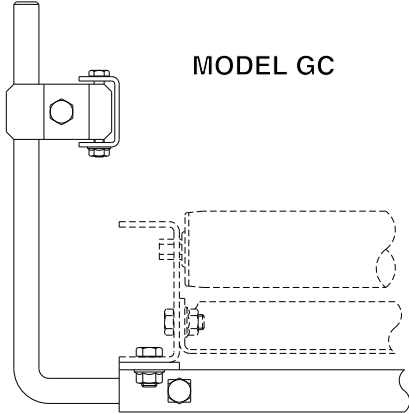

**MODEL GA1.5
MODEL HGA1.5**

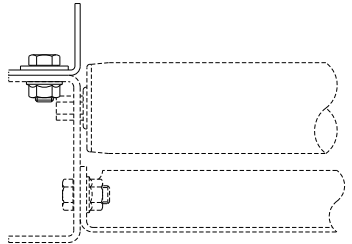

**ALWAYS SPECIFY CONVEYOR MODEL NUMBER AND
FLANGE WIDTH GUARD RAILS WILL MOUNT ON**

MODEL FSG

**FSG CURVE GUARDS
DO NOT HAVE TURN DOWN
ON TOP FLANGE**

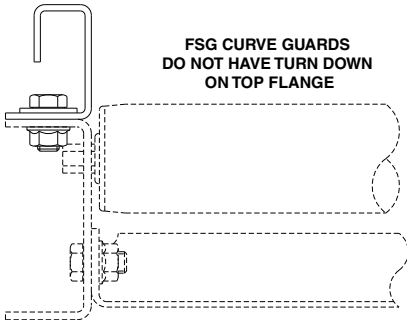

MODEL FC

**3.5" SPACER CHANNEL
(3 SUPPLIED PER 10' SECTION)**

